



**MARCO® 400 CFM
CART MOUNTED AFTERCOOLER
WITH MOISTURE SEPARATOR**



Powered by **ALLREDI**.

PART NUMBERS AND SCHEMATICS GUIDE

Company Profile

Allredi was formed in the early 2020, when two of the largest distributors in the blasting, coating, safety, and environmental industry, APE Companies and Marco Group International, joined forces. While the qualities both companies are known for have not changed, a lot about our business is new. New abilities. New agilities. New ways to help you win. This calls for a new name, Allredi.

This name exemplifies what we have become. It is completely oriented to the needs of our customers. To your needs. It says that when you call us for anything – products, service, expert advice, anything – you can consider it done. Or even better, Allredi done.

We are your right-now supplier. From skills to SKUs, we deliver the goods fast. So you can be more agile every minute, every day. This is who we are. This is what our new name means. Go ahead and expect excellence, because we're bringing it.

Our Mission and Vision

To be the industry's preferred partner in surface preparation solutions through unrivaled technical expertise, customer experience, product availability, and tailored service offerings.

The Allredi Difference

- **Industry Experience** – With Allredi on your team, you have access to expertise which can only come from decades of industry leadership. We have organized our engineering department, production specialists, customer operations, and safety support into a “Center of Competence.” As an Allredi customer, you have access to hundreds of years of cumulative experience related to your operations.
- **Manufacturing Excellence** – Allredi is a U.S. based manufacturer of equipment for the Surface Preparation and Protective Coatings industries. Allredi's engineers benchmark the industry to ensure that we design and manufacture superior products that set the “Gold Standard” for performance, safety, and quality.
- **Legendary Customer Service** – Allredi's legendary customer service team is staffed by friendly, highly-trained individuals who are focused on providing the highest level of product support, order accuracy, and customer satisfaction.
- **Product Availability** – We stock over 10,000 SKU's and have over 45 shipping locations to serve North American and International markets for all major brands of blasting, coating, environmental, and safety equipment. Allredi is your right-now supplier, so you can keep your projects moving. From our foundation of strong relationships, we have built a nationwide network that puts vast inventory and ready service close to our customers. We provide advanced expertise, and we deliver the goods fast – so you can easily access the products and services you need to me more agile every minute, every day.
- **Technology Leadership** – Our website provides: Operator's Manuals, Part Numbers and Schematics Guides, SDS information, and key product features and specifications, providing access to information 24/7.

TABLE OF CONTENTS

Company Profile	2
Table of Contents	3
Part Numbers	4
Specifications	5
Part Numbers and Schematics	6-10
Marco® 400 CFM Cart Mounted Aftercooler With Moisture Separator—Pneumatic	6-7
Aftercooler Assembly—Pneumatic	8
Air Regulator/Lubricator	9
Transfer Hose Assembly	10
Optional Accessories	11-13
1-1/2" Extractor Moisture Separator Assembly	11
Airflow Shutoff Kits – Lug Fittings	12
Airflow Shutoff Kits – Hammerlock Fittings	12
Pipe Plugs	13
Lubrication	13
Maintenance Notes	14-15

PART NUMBERS

MARCO® 400 CFM CART MOUNTED AFTERCOOLER WITH MOISTURE SEPARATOR

	Inlet			Outlet			
	Inlet Quantity	Inlet Size	Fittings	Outlet Quantity	Outlet Size	Fittings	
Part Numbers							Filter, Regulator, and Lubricator
10103924	1	2"	Included	5	(1) 2", (4) 1"	Not Included	Included

* Inlet fittings include 2" 4-Lug Female Coupling.



SPECIFICATIONS

Lubrication: SAE 10 oil or Air Tool Anti-freeze Lubricant

Empty Weight: 385 Pounds

Overall Dimensions: A: 49 1/4"
B: 30 1/2"
C: 42 1/2"

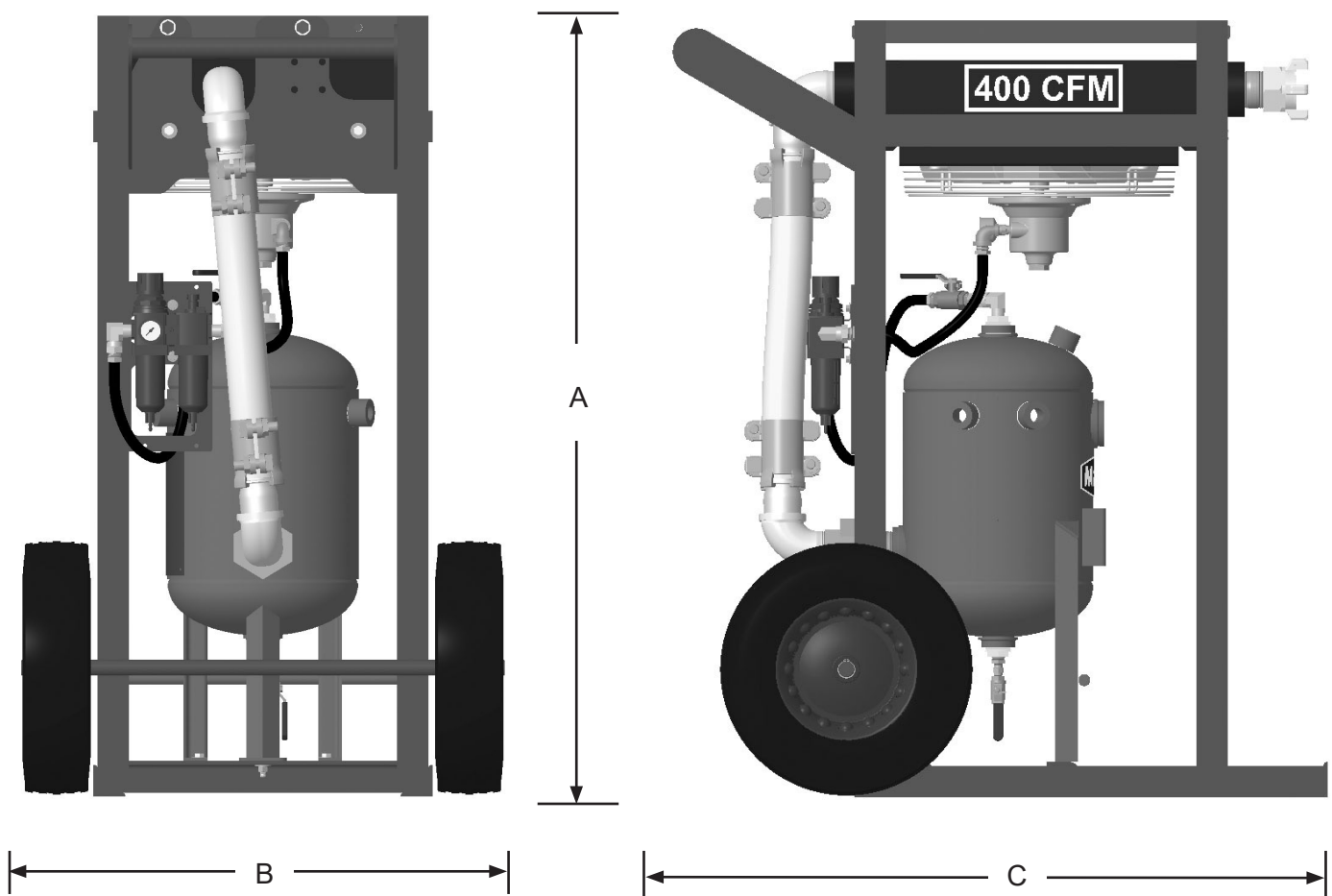

PART NUMBERS AND SCHEMATICS

Marco® 400 CFM Cart Mounted Aftercooler With Moisture Separator—Pneumatic

Item #	Part #	Description
Fig. 1		
—	10103924	Marco® 400 CFM Cart-Mounted Aftercooler with Moisture Separator – Complete
1	10101943	1/2-13 x 1-3/4" Hex Bolt (<i>Four Required</i>)
2	10100674	1/2" Flat Washer (<i>Eight Required</i>)
3	10100675	1/2" Lock Washer (<i>Four Required</i>)
4	10101941	1/2-13 Hex Nut (<i>Four Required</i>)
5	10101271	Heat Exchanger Protective Grate
6	10TTAHP4005	400 CFM Aftercooler – Complete (<i>See Fig. 2</i>)
7	1006064	Wheel (<i>Two Required</i>)
8	1006205	Wheel Clip (<i>Four Required</i>)
9	10108972	Frame
10	10101318	800 CFM 6-Outlet Aftercooler Tank
11	10101059	3/8-6 x 1-1/4" Galvanized Bolt (<i>Seven Required</i>)
12	10101942	3/8" Galvanized Flat Washer (<i>14 Required</i>)
13	10L805015	3/8" Galvanized Lock Washer (<i>Seven Required</i>)
14	10101938	3/8-16 Galvanized Hex Nut (<i>Seven Required</i>)
15	10ME5	2" 4-Lug Female NPT Coupling
16	1001806	2" Close Nipple - Galvanized (<i>Two Required</i>)
17	—	Transfer Hose Assembly (<i>See Fig. 4</i>)
18	10101784	Muffer
19	1017019	1/4" NPT Hex Nipple (<i>Two Required</i>)
20	10101185	1/2" x 1/4" NPT 90° Reducing Elbow
21	10PAF050	1/2" Push-on Air Hose Fitting (<i>Four Required</i>)
22	10AH012	1/2" I.D. Air Hose (<i>Per Foot</i>)
23	1011820	1-1/4" to 1/2" NPT Bushing (<i>Two Required</i>)
24	10SAP1290	1/2" NPT 90° Swivel (<i>Three Required</i>)
25	10101232	Air Regulator/Lubricator with Pressure Gauge (<i>See Fig. 3</i>)
26	10L363	1/2" Full Port Ball Valve
27	1011818	1/2" x 1/4" Galvanized Bushing
28	1080050	1/4" Ball Valve
29	20100677	1/2" NPT Hex Nipple
30	1094535	400 CFM Decal (<i>Two Required</i>)
—	1091045	Hazard Identification Tag
—	106M108	Part Numbers and Schematics Guide – Marco® 400 CFM Cart-Mounted Aftercooler with Moisture Separator
—	1091108	Operator's Manual – Marco® 400 CFM Cart-Mounted Aftercooler with Moisture Separator

PART NUMBERS AND SCHEMATICS

Figure 1: Marco® 400 CFM Cart Mounted Aftercooler With Moisture Separator—Pneumatic

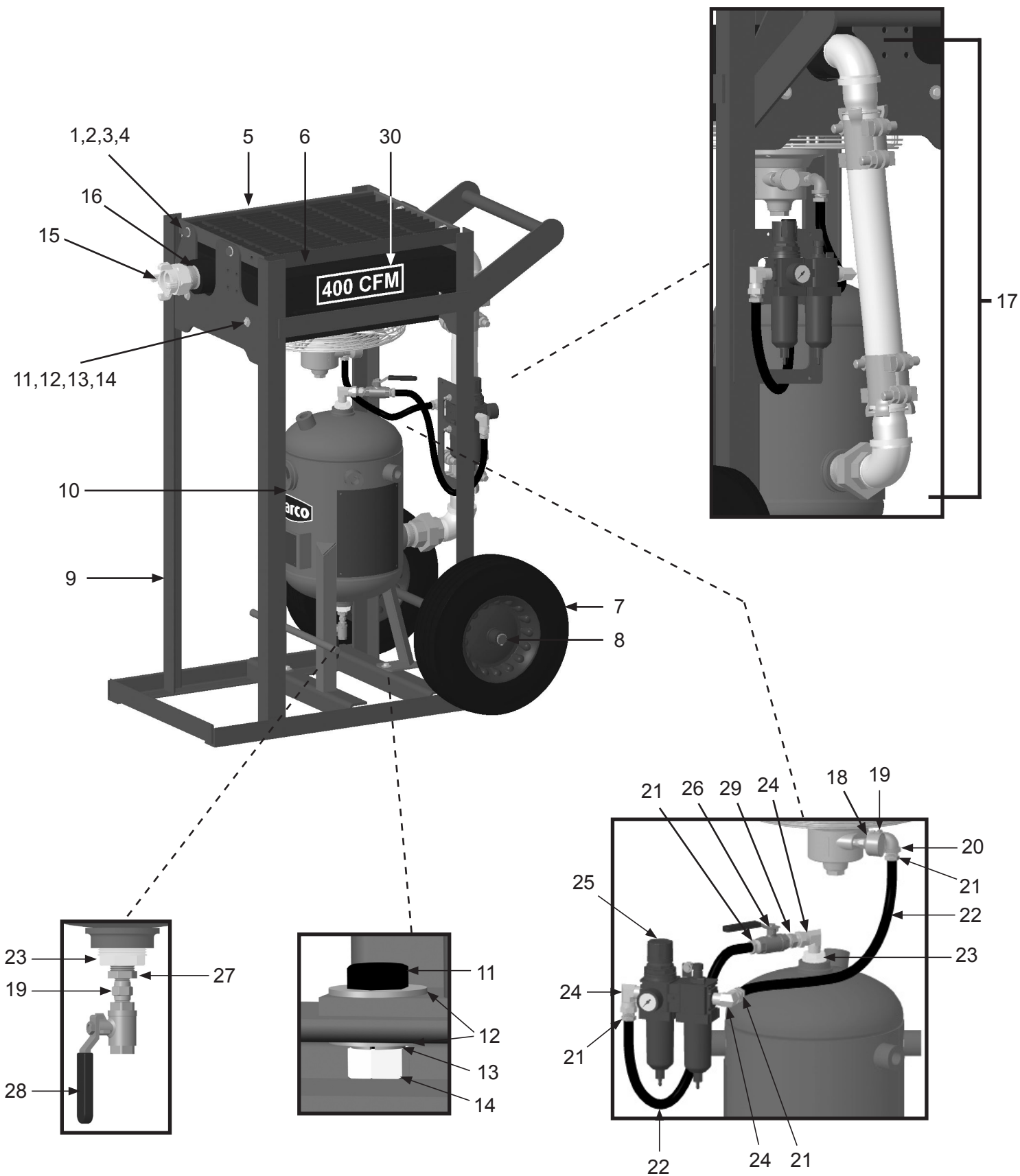

PART NUMBERS & SCHEMATICS

Figure 2: Aftercooler Assembly—Pneumatic

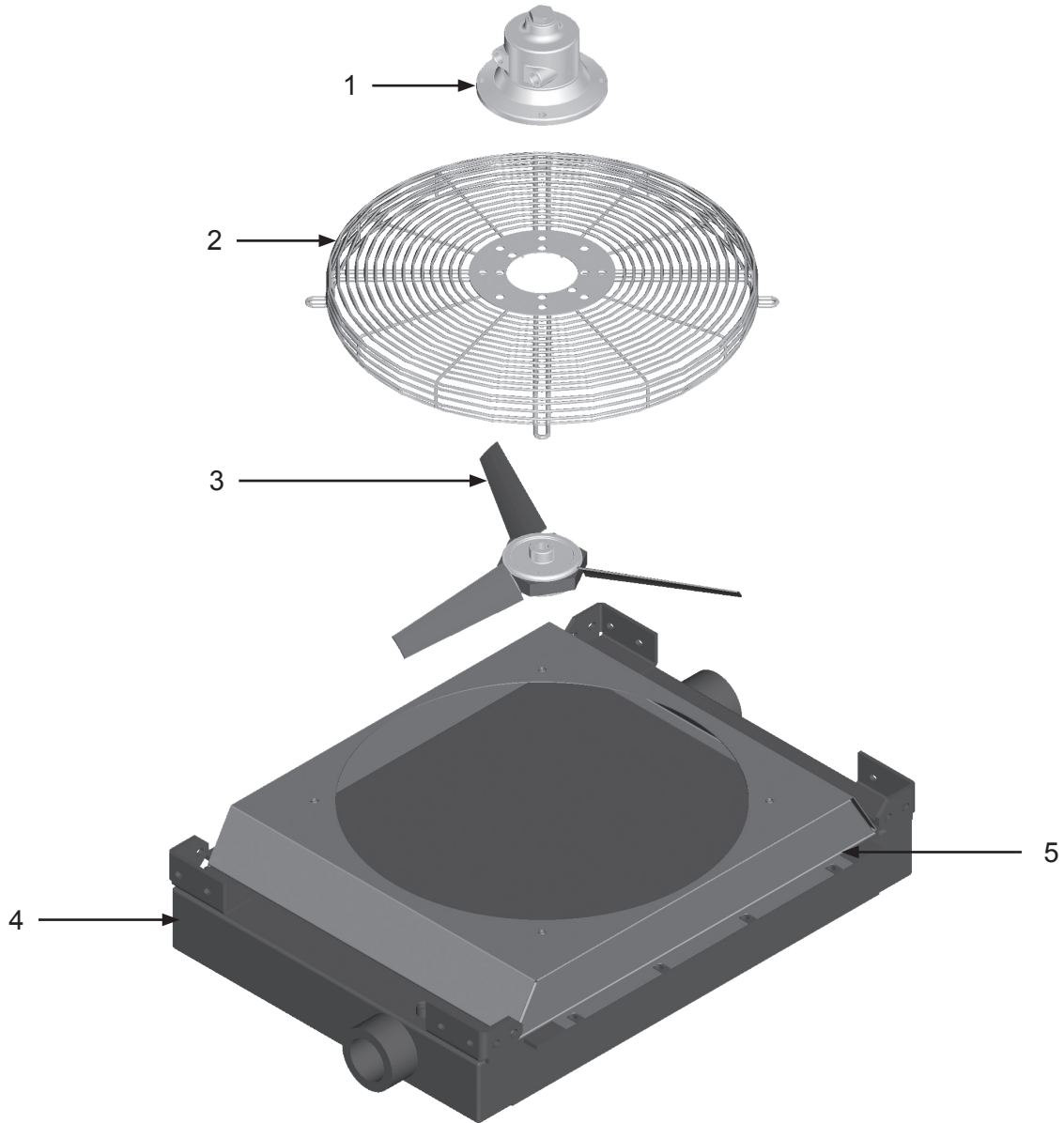

Item #	Part #	Description
Fig. 2		
—	10TTAHP4005	400 CFM Aftercooler—Pneumatic—Complete
1	10101780	Air Motor
2	10101788	Fan Guard
3	10101787	Fan Blade Assembly (Includes three Blades and Hub)
4	10103983	Fan Shroud
5	10101786	Aftercooler Core
—	10101781	Air Motor Service Kit <i>Includes: Shaft Seal, Drive End Bearing, Dead End Bearing, Vanes (Quantity of Four), Push Pins (Quantity of Four), Vane Springs (Quantity of Four), Shim, End Cap Gasket, Muffler Cartridge, and Muffler Felt</i>

PART NUMBERS AND SCHEMATICS

Figure 3: Air Regulator/Lubricator

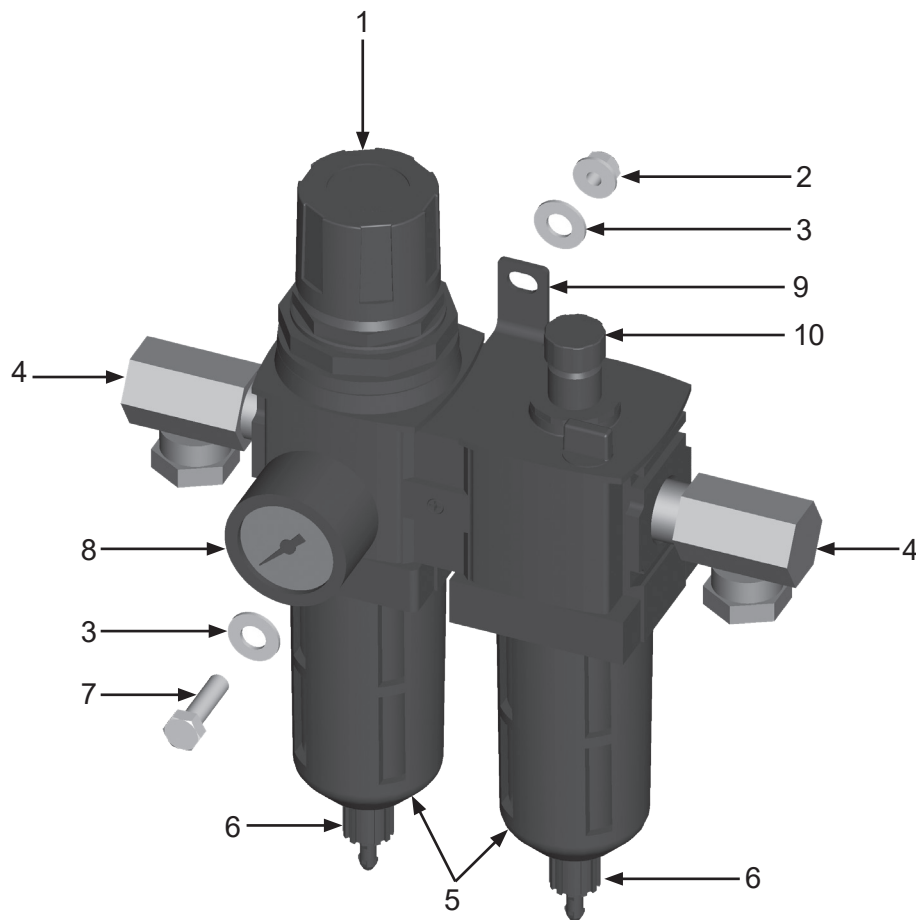

Item #	Part #	Description
--------	--------	-------------

Fig. 3

1	10101232	Filter/Regulator/Lubricator with Pressure Gauge
2	1012323	1/4" Nylon Insert Lock Nut <i>(Two Required)</i>
3	1014017	1/4" Flat Washer <i>(Four Required)</i>
4	10SAP1290	1/2" 90° Swivel <i>(Two Required)</i>
5	10101235	Polycarbonate Bowl - Wilkerson <i>(Two Required)</i>
	10109913	Bowl With O-Ring - Midwest Control <i>(Two Required)</i>
6	10101234	Manual Drain - Wilkerson
	10109914	Manual Drain - Midwest Control
7	1012154	1/4-20 X 1" Bolt <i>(Two Required)</i>
8	1028606	Pressure Gauge – 0-160 PSI 1/4" – Back Mount
9	10109907	Quick Clamp with Bracket - Midwest Control
10	10109912	Sight Dome - Midwest Control
–	10101233	Filter Element - Wilkerson
	10109915	Filter Element 40 Micron - Midwest Control
–	1070517	Pneumatic Air Tool Oil–32 oz. bottle

PART NUMBERS AND SCHEMATICS

Figure 4: Transfer Hose Assembly

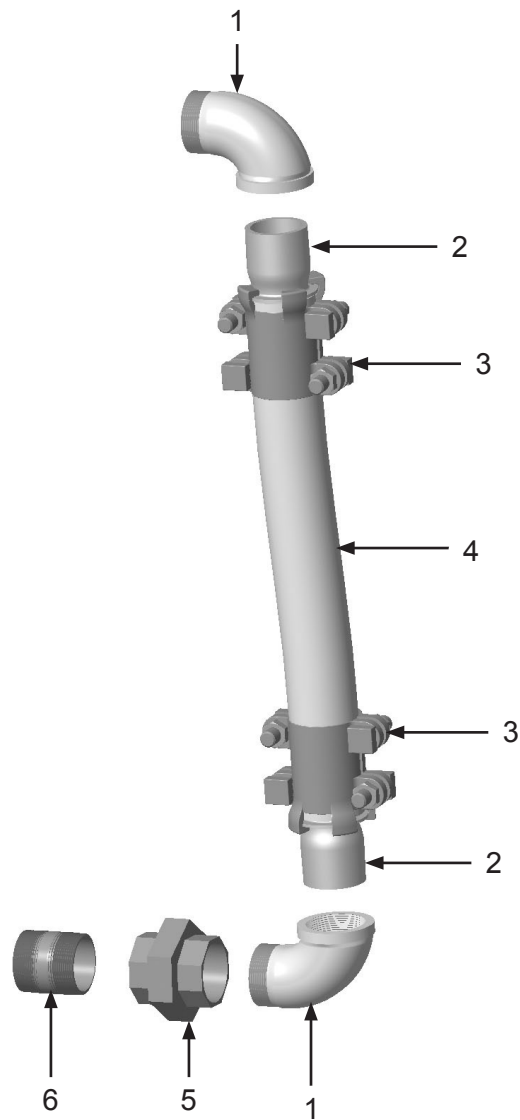

Item #	Part #	Description
--------	--------	-------------

Fig. 4

1	10101265	2" 90° Street Elbow (<i>Two Required</i>)
2	10101268	2" NPT Male Boss Stem (<i>Two Required</i>)
3	10BU28	2" Boss Clamp (<i>Two Required</i>)
4	10101269	2" I.D. Steel Reinforced Air Hose (<i>Per Foot</i>)
5	10101267	2" NPT Pipe Union
6	1001806	2" NPT Close Nipple

OPTIONAL ACCESSORIES

Figure 5: 1-1/2" Extractor Moisture Separator Assembly

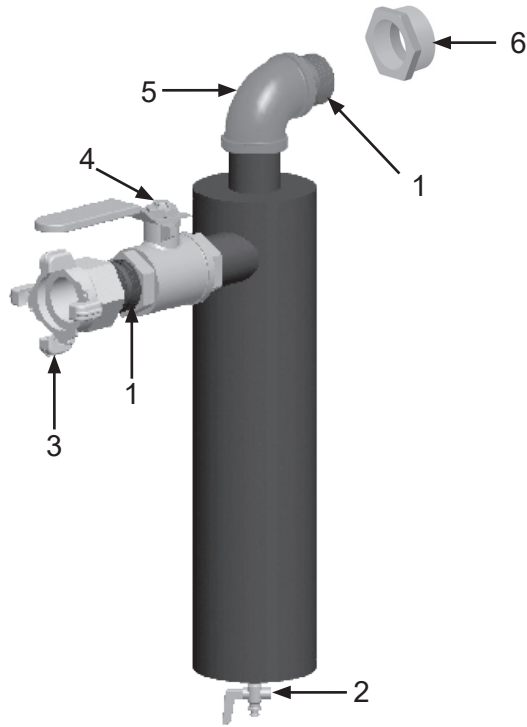

Item #	Part #	Description
--------	--------	-------------

Fig. 5

–	10101313	Marco® 1-1/2" Extractor Moisture Separator <i>Includes Item #: 1, 2, 3, 4, and 5</i>
---	----------	---

1	1014015	1-1/2" NPT Close Nipple (<i>Two Required</i>)
---	---------	---

2	1012101	1/4" NPT Brass Petcock
---	---------	------------------------

3	10ME4	4-Lug Air Hose Fitting – 1-1/2" NPT (F)
---	-------	---





4	1011603	1-1/2" NPT Full Port Brass Ball Valve
---	---------	---------------------------------------





5	1011842	1-1/2" NPT 90° Elbow
---	---------	----------------------

6	1001868	2" x 1-1/2" Hex Bushing
---	---------	-------------------------





—	106M349	Part Numbers and Schematics Guide – Marco® Extractor Moisture Separators
---	---------	--

OPTIONAL ACCESSORIES

		AIRFLOW SHUTOFF KITS – LUG FITTINGS			
	Part Numbers	Pipe String I.D.	Close Nipple	Full Port Ball Valve	Coupling
	10103731	1"	1012151	1011601	10ME2
	10103732	1-1/4"	1011201 <i>(Quantity of Two)</i>	1011602	10ME3
	10103733	1-1/2"	1014015 <i>(Quantity of Two)</i>	1011603	10ME4
	10103734	2"	1001806 <i>(Quantity of Two)</i>	1011604	10ME5

		AIRFLOW SHUTOFF KITS – HAMMERLOCK FITTINGS			
	Part Numbers	Pipe String I.D.	Close Nipple	Full Port Ball Valve	Coupling Spud
	10103830	1"	10102151 <i>(Quantity of Two)</i>	1011601	10DXGB13
	10103831	1-1/4"	1011201 <i>(Quantity of Two)</i>	1011602	10DXGB18
	10103832	1-1/2"	1014015 <i>(Quantity of Two)</i>	1011603	10DXGB23
	10103833	2"	1001806 <i>(Quantity of Two)</i>	1011604	10DXGB28
	10103934	3"	10101040 <i>(Quantity of Two)</i>	1011608	10GB38

OPTIONAL ACCESSORIES

Part Numbers		GALVANIZED SQUARE HEAD PIPE PLUGS
		Size
	1011901	1"
	1011902	1-1/4"
	1011101	1-1/2"
	1011823	2"
	10101034	3"

Part Numbers	LUBRICATION
1070517	Pneumatic Air Tool Oil - 32 oz. bottle

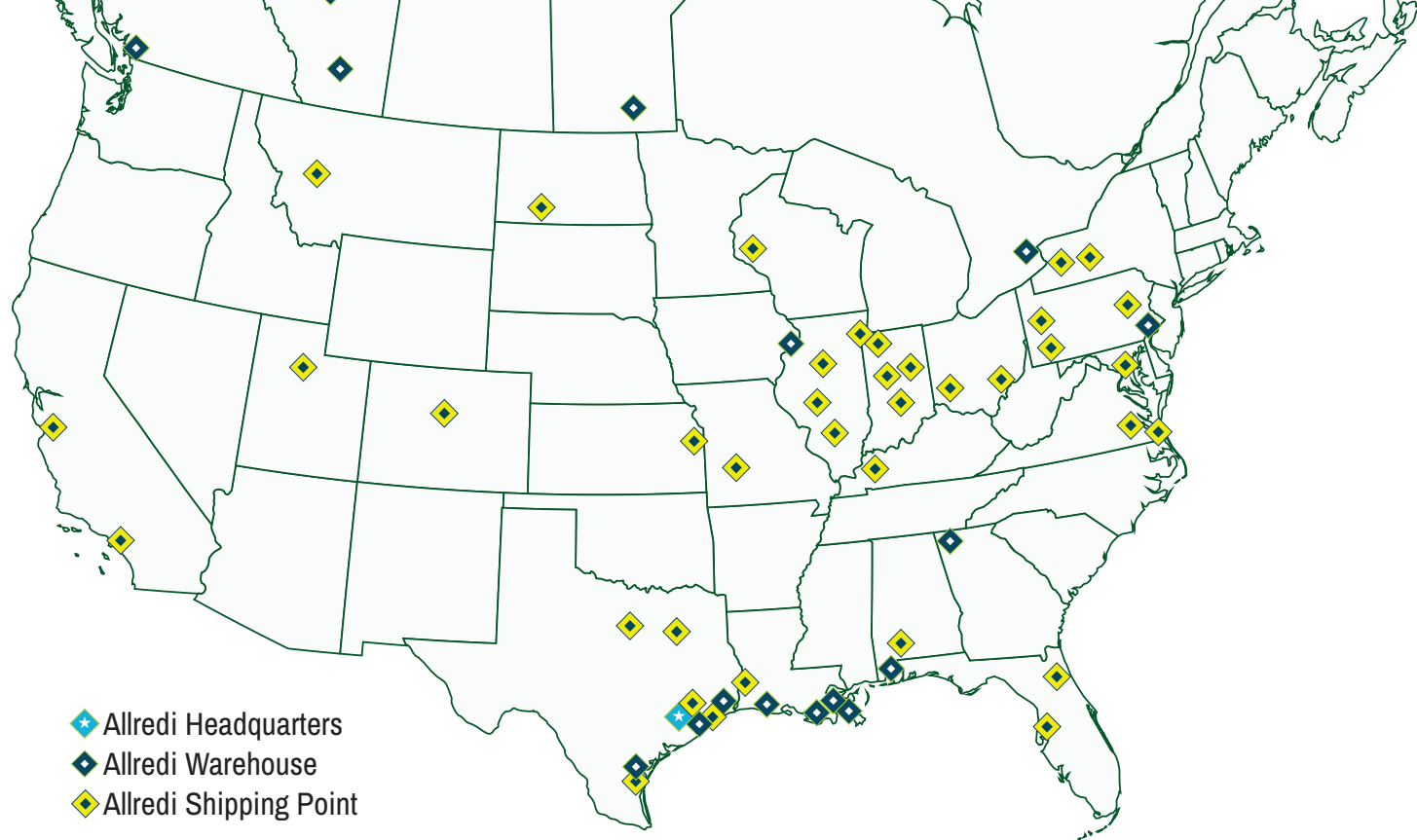

ALLREDI THERE

Serving these industries: Bridge, Pipeline, Tank & Tower, Concrete Services, Rail, Shipyard & Marine, Pools & Fountains, and Foundry

UNITED STATES

Pasadena, TX (Headquarters)
844.361.7038

Beaumont, TX
409.722.1284

Bristol, PA
215.826.8080

Corpus Christi, TX
361.887.2038

Davenport, IA
563.324.2519

Deer Park, TX
(Service & Rental Location)
281.930.0905

Duluth, GA
800.535.4564

Gonzales, LA
225.647.7575

Harvey, LA
504.367.8090

Houma, LA
985.580.4273

Lafayette, LA
337.267.1440

Theodore, AL
251.338.7525

CANADA

Calgary, Alberta
403.279.1924

Coquitlam, BC
604.464.6979

Edmonton, Alberta
780.468.2588 (Manus)
780.425.5510 (Mod-U-Blast)

Hamilton, Ontario
905.527.6000 / 888.794.5665

Mississauga, Ontario
905.890.5837

Winnipeg, Manitoba
204.256.3324

800.BLAST.IT / WWW.ALLREDI-US.COM

Allredi™ and Marco® are registered trademarks of Allredi, LLC.
All other brand names or marks are used for identification purposes and are trademarks of their respective owners.

ALLREDI™

Literature #106M108_1/19/2024