



# HAZARDOUS LOCATION LIGHTS



# PART NUMBERS AND SCHEMATICS GUIDE

## Company Profile

Allredi was formed in the early 2020, when two of the largest distributors in the blasting, coating, safety, and environmental industry, APE Companies and Marco Group International, joined forces. While the qualities both companies are known for have not changed, a lot about our business is new. New abilities. New agilities. New ways to help you win. This calls for a new name, Allredi.

This name exemplifies what we have become. It is completely oriented to the needs of our customers. To your needs. It says that when you call us for anything – products, service, expert advice, anything – you can consider it done. Or even better, Allredi done.

We are your right-now supplier. From skills to SKUs, we deliver the goods fast. So you can be more agile every minute, every day. This is who we are. This is what our new name means. Go ahead and expect excellence, because we're bringing it.

## Our Mission and Vision

To be the industry's preferred partner in surface preparation solutions through unrivaled technical expertise, customer experience, product availability, and tailored service offerings.

## The Allredi Difference

- **Industry Experience** – With Allredi on your team, you have access to expertise which can only come from decades of industry leadership. We have organized our engineering department, production specialists, customer operations, and safety support into a "Center of Competence." As an Allredi customer, you have access to hundreds of years of cumulative experience related to your operations.
- **Manufacturing Excellence** – Allredi is a U.S. based manufacturer of equipment for the Surface Preparation and Protective Coatings industries. Allredi's engineers benchmark the industry to ensure that we design and manufacture superior products that set the "Gold Standard" for performance, safety, and quality.
- **Legendary Customer Service** – Allredi's legendary customer service team is staffed by friendly, highly-trained individuals who are focused on providing the highest level of product support, order accuracy, and customer satisfaction.
- **Product Availability** – We stock over 10,000 SKU's and have over 45 shipping locations to serve North American and International markets for all major brands of blasting, coating, environmental, and safety equipment. Allredi is your right-now supplier, so you can keep your projects moving. From our foundation of strong relationships, we have built a nationwide network that puts vast inventory and ready service close to our customers. We provide advanced expertise, and we deliver the goods fast – so you can easily access the products and services you need to me more agile every minute, every day.
- **Technology Leadership** – Our website provides: Operator's Manuals, Part Numbers and Schematics Guides, SDS information, and key product features and specifications, providing access to information 24/7.

## TABLE OF CONTENTS

<b>Company Profile</b> .....	<b>2</b>
<b>Table of Contents</b> .....	<b>3</b>
<b>Hazardous Location Lights</b> .....	<b>4-8</b>
Appleton® Hazardous Location Area Light . . . .	4-5
Haztex® Hazardous Location Work Light . . . . .	6-7
Hazardous Location Flash Light . . . . .	8
<b>Optional Accessories</b> .....	<b>9</b>
<b>Maintenance Notes</b> .....	<b>10-11</b>

PART NUMBERS AND SCHEMATICS GUIDE

Part Number	APPLETON® HAZARDOUS LOCATION AREA LIGHT					
	Application	Light Stand	14/3 Electric Cord	Power Source	Light Bulb	Manufacturer
1030600	Class 1, Division 1; Group C & D	X	75 Feet	120-Volt	300 Watt	Appleton®



PART NUMBERS & SCHEMATICS

Figure 1: Appleton® Hazardous Location Area Light

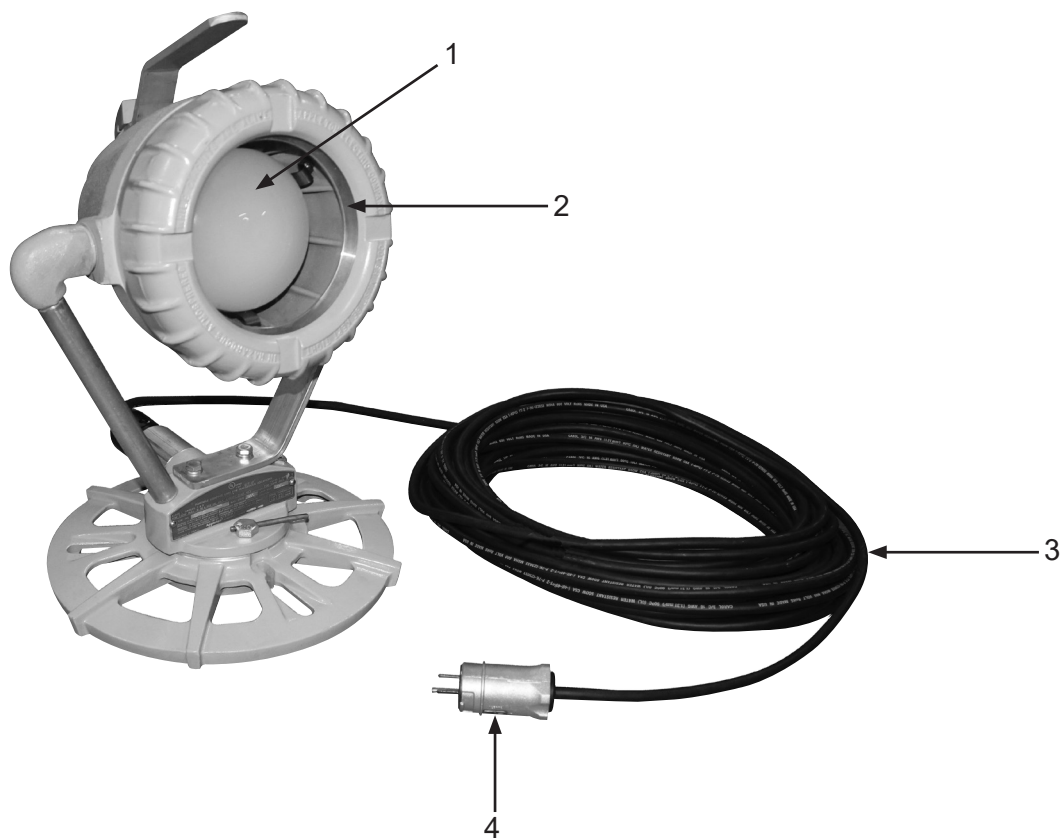

Item #	Part #	Description
<b>Fig. 1</b>		
—	<b>1030600</b>	<b>Appleton® Hazardous Location Area Light with 75 Feet of Electric Cord and Plug – Complete</b>
1	1030613	300 Watt Bulb
2	1030611	Lens Assembly <i>Includes Lens Collar and Retaining Ring</i>
3	1015550	14/3 Electric Cord (Per Foot)
4	1030614	Water Resistant Male Plug
—	1030616	Socket
—	106M447	Part Numbers & Schematics Guide – Hazardous Location Lights
—	109V048	Operator's Manual – Appleton® Hazardous Location Area Light

PART NUMBERS AND SCHEMATICS GUIDE

Part Number	HAZTEX® HAZARDOUS LOCATION WORK LIGHT				
	Application	Light Bulb	Power Source	14/3 Electric Cord with Plug	Manufacturer
pending	Class 1, Division 1; Group C & D	LED	120-Volt	75 Feet	Woodhead® Molex®

Assembly with 75 Watt bulb discontinued by manufacturer in 2020. LED option available. See your sales rep or supply chain for pricing and part numbers.



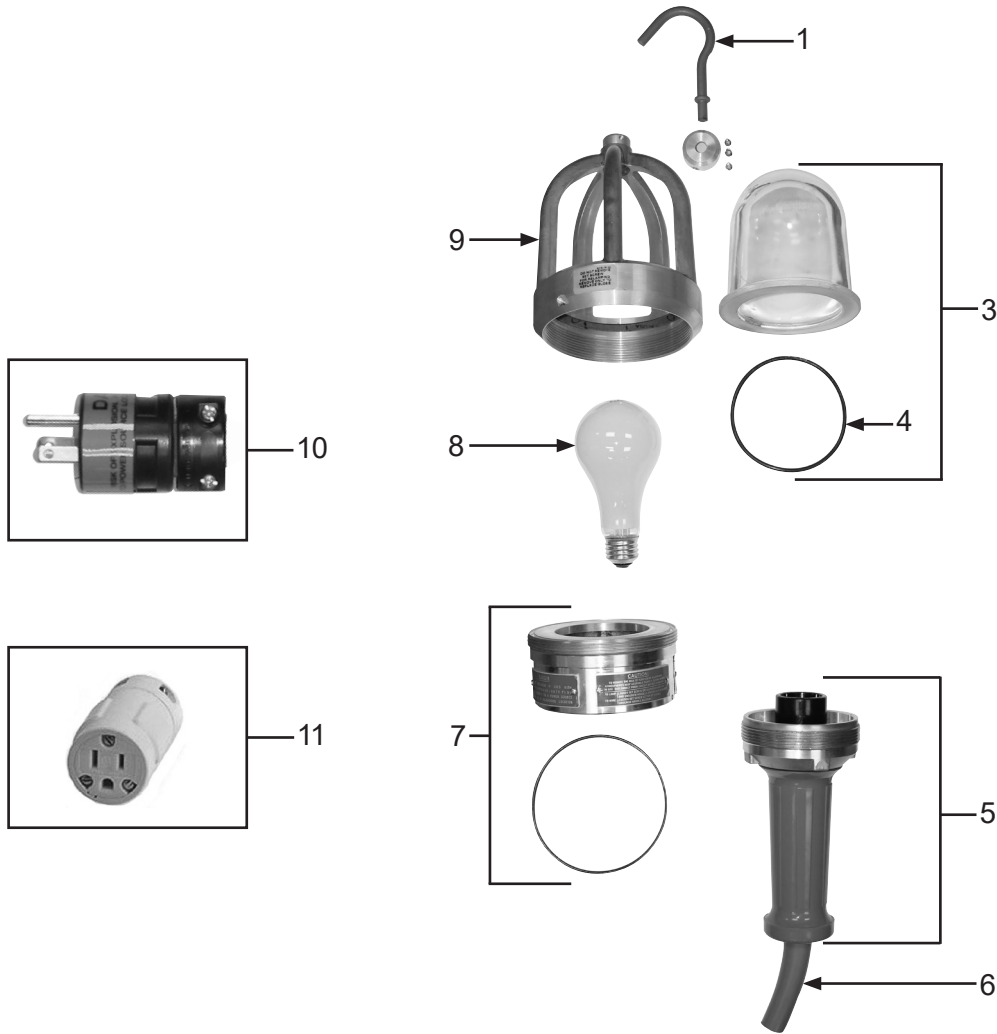

## PART NUMBERS AND SCHEMATICS GUIDE

Figure 2: Haztex® Hazardous Location Work Light





Item #	Part #	Description
<b>Fig. 2</b>		
1	1030413	Hook (Includes Collar and Screws)
3	1030412	Globe and Gasket Includes Item #4
4	1030418	Gasket
5	1030415	Handle and Socket
6	1030419	Grommet
7	1030417	Retaining Nut and Gasket
8	—	Halogen bulb discontinued by manufacturer. LED available. See your sales rep or supply chain for pricing and part numbers.
9	1030411	Guard and Globe Includes Item #3
10	1030026	3-Prong Male Plug
11	1070192	3-Prong Female Plug
—	106M447	Part Numbers and Schematics Guide – Hazardous Location Lights
—	109V047	Operator's Manual – Woodhead® Hazardous Location Work Light
—	109V709	Technical Data Sheet – Haztex® Hazardous Location Work Light

## PART NUMBERS AND SCHEMATICS GUIDE

	Part Numbers	FLASHLIGHTS		
		Application	Batteries	Color
	1070054	Class 1, Division 1; Group C & D	D-Cell ( <i>Quantity of Two*</i> )	Orange
	1070090	Class 1, Division 1; Group C & D	C-Cell ( <i>Quantity of Three*</i> )	Varies

*\*Batteries not included*

	Part Numbers	BATTERIES	
		Brand	Size
	1070013	Duracell®	C
	1070012	Duracell®	D



# OPTIONAL ACCESSORIES

	Part Numbers	ELECTRIC CONTROL LINE			
		Gauge	# of Wires	Type	Length
	1015550	14	3	SEOOW	Per Foot
	1015571	12	3	SJEOOW	Per Foot
	1015581	10	3	SEOOW	Per Foot
	1015591	8	3	SEOOW	Per Foot
	1015595	6	3	SEOOW	Per Foot

## MAINTENANCE NOTES

[illegible]

## MAINTENANCE NOTES

[illegible]

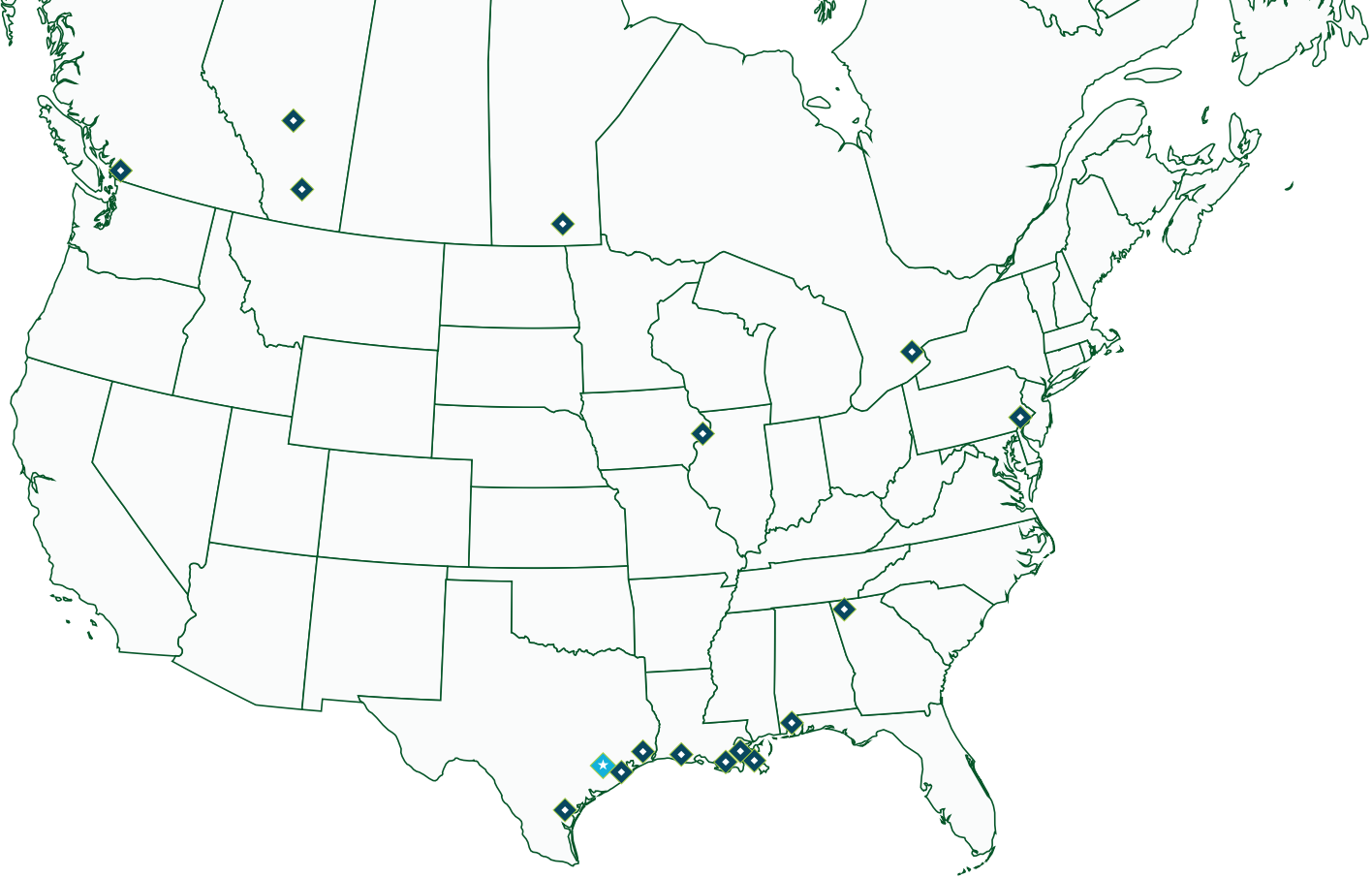

## ALLREDI THERE

Serving these industries: Bridge, Pipeline, Tank & Tower, Concrete Services, Rail, Shipyard & Marine, Pools & Fountains, and Foundry

### UNITED STATES

**Pasadena, TX (Headquarters)**  
844.361.7038

**Beaumont, TX**  
409.722.1284

**Bristol, PA**  
215.826.8080

**Corpus Christi, TX**  
361.887.2038

**Davenport, IA**  
563.324.2519

**Deer Park, TX**  
(Service & Rental Location)  
281.930.0905

**Duluth, GA**  
800.535.4564

**Gonzales, LA**  
225.647.7575

**Harvey, LA**  
504.367.8090

**Houma, LA**  
985.580.4273

**Lafayette, LA**  
337.267.1440

**Theodore, AL**  
251.338.7525

### CANADA

**Calgary, Alberta**  
403.279.1924

**Coquitlam, BC**  
604.464.6979

**Edmonton, Alberta**  
780.468.2588 (Manus)  
780.425.5510 (Mod-U-Blast)

**Hamilton, Ontario**  
905.527.6000 / 888.794.5665

**Mississauga, Ontario**  
905.890.5837

**Winnipeg, Manitoba**  
204.256.3324

**800.BLAST.IT / WWW.ALLREDI-US.COM**

Allredi™ and Marco® are registered trademarks of Allredi, LLC.  
All other brand names or marks are used for identification purposes and are trademarks of their respective owners.

**ALLREDI™**

Literature #106M447\_7/18/2023